

WEHRLE

DEVELOPMENT, LTD.

WWW. WEHRLE DEVELOPMENT.COM

CALL TODAY FOR MORE INFORMATION 419-841-5363

6909 Deer Ridge Dr. Temperance, MI. 48182

Lot #146 Hickory Creek – 2268 Sq. ft. - 2 story,
5 bedrooms, 3 full baths, full basement, 1st floor
laundry room. Granite counters kitchen.
Hardwood floors kitchen, dinette and foyer.
Ceramic tile all baths and laundry room
9 ft. 1st Floor Ceilings, Vaulted ceilings great
room and front bedroom. Balcony overlooking
the great room. You still have time to choose
your color choices.



FRONT ELEVATION

Price \$254,900

This beautiful 2 story Includes a master bedroom and bath with a large walk-in closet. Vaulted ceilings in the great room and front bedroom, with scraped hardwood floors and ceramic tile. The open floor plan concept includes 9' first floor ceilings, custom cabinets with granite counters and stainless steel appliances. The exterior of this home includes 18' drive, stone exterior, 12X12 concrete patio, landscaping and the yard hydro seeded.

Customized for your needs!

We offer many opportunities to create a living space flexible for your needs. Our up to date interiors are custom and provide you with more choices, and more colors.

We offer co-operate with real estate agents

Lots Available for you to Build!

We have many lots to choose from. Reserve your lot today and let us build your new home!

Sales Consultant

Cyndi Sculfort 419-367-5227

email: cyndi@wehrledevelopment.com

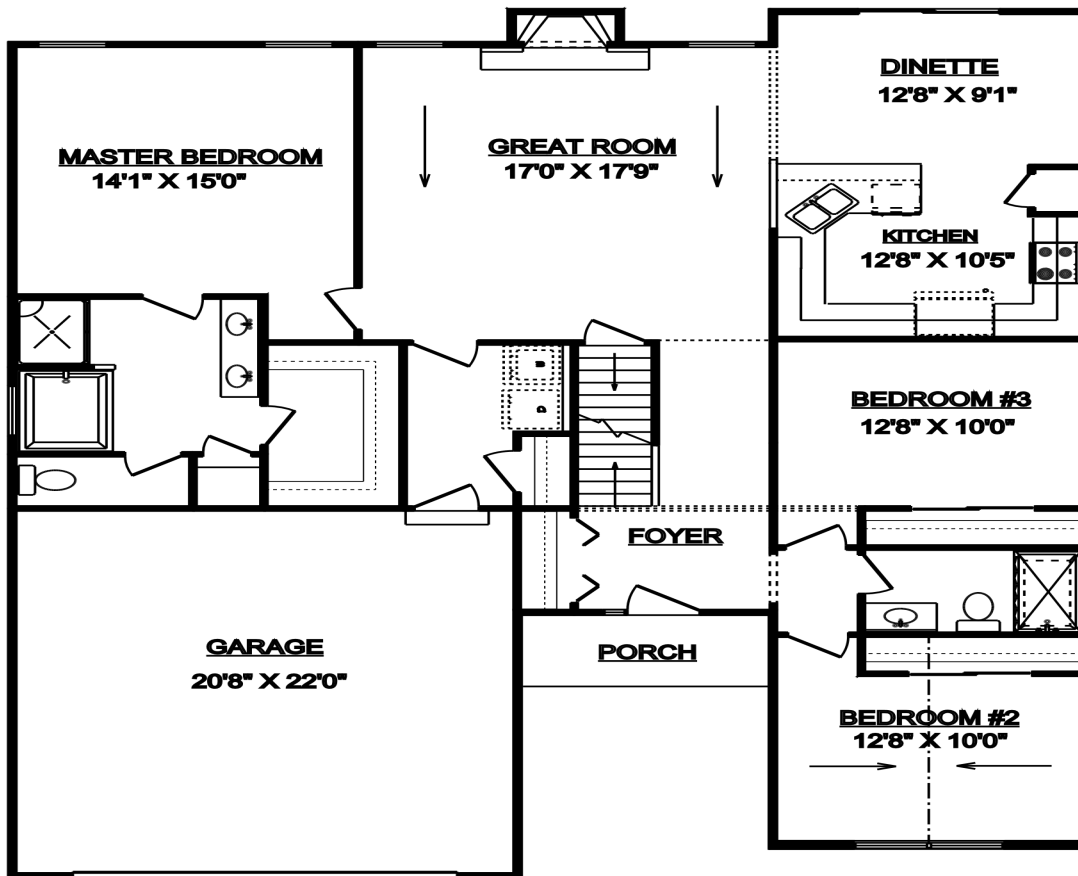

FIRST FLOOR PLAN

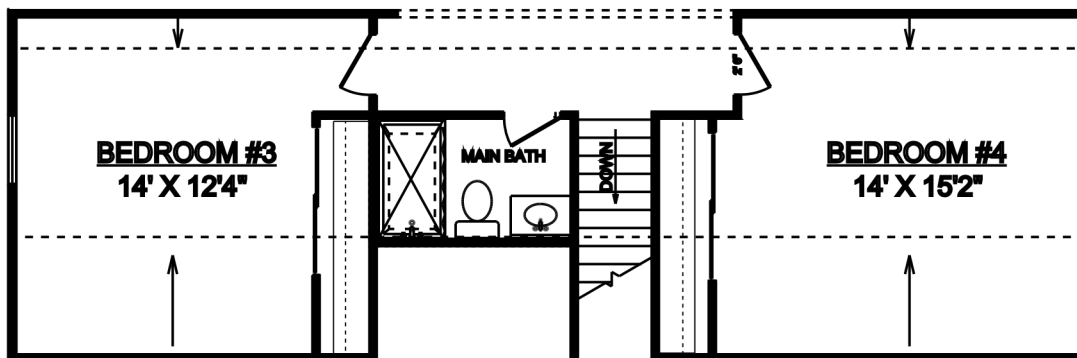

SECOND FLOOR PLAN