

# WEHRLE

DEVELOPMENT, LTD.

**WWW. WEHRLE DEVELOPMENT.COM**

**CALL TODAY FOR MORE INFORMATION 419-841-5363**

6890 Deer Ridge Dr. Temperance, MI. 48182

**Lot #154 Hickory Creek** – 2268 Sq. ft. - 2 story,  
5 bedrooms, 3 full baths, full basement, 1<sup>st</sup> floor  
laundry room. Granite counters kitchen.  
Hardwood floors kitchen, dinette and foyer.  
Ceramic tile all baths and laundry room  
9 ft. 1<sup>st</sup> Floor Ceilings, Vaulted ceilings great  
room and front bedroom. Balcony overlooking  
the great room. You still have time to choose  
your color choices.



FRONT ELEVATION

**Price \$249,900 Sold**

**This beautiful 2 story on a wooded private lot comes with a master bedroom and bath with a large walk-in closet. Vaulted ceilings in the great room, with scraped hardwood floors and ceramic tile included. The open floor plan concept includes 9' first floor ceilings, custom cabinets with granite counters and stainless steel appliances. The exterior of this home includes 18' drive and stone exterior.**

## **Customized for your needs!**

We offer many opportunities to create a living space flexible for your needs. Our up to date interiors are custom and provide you with more choices, and more colors.

We offer co-operate with real estate agents

## **Lots Available for you to Build!**

We have many lots to choose from. Reserve your lot today and let us build your new home!

Sales Consultant

**Cyndi Sculfort 419-367-5227**

**email: [cyndi@wehrledevelopment.com](mailto:cyndi@wehrledevelopment.com)**

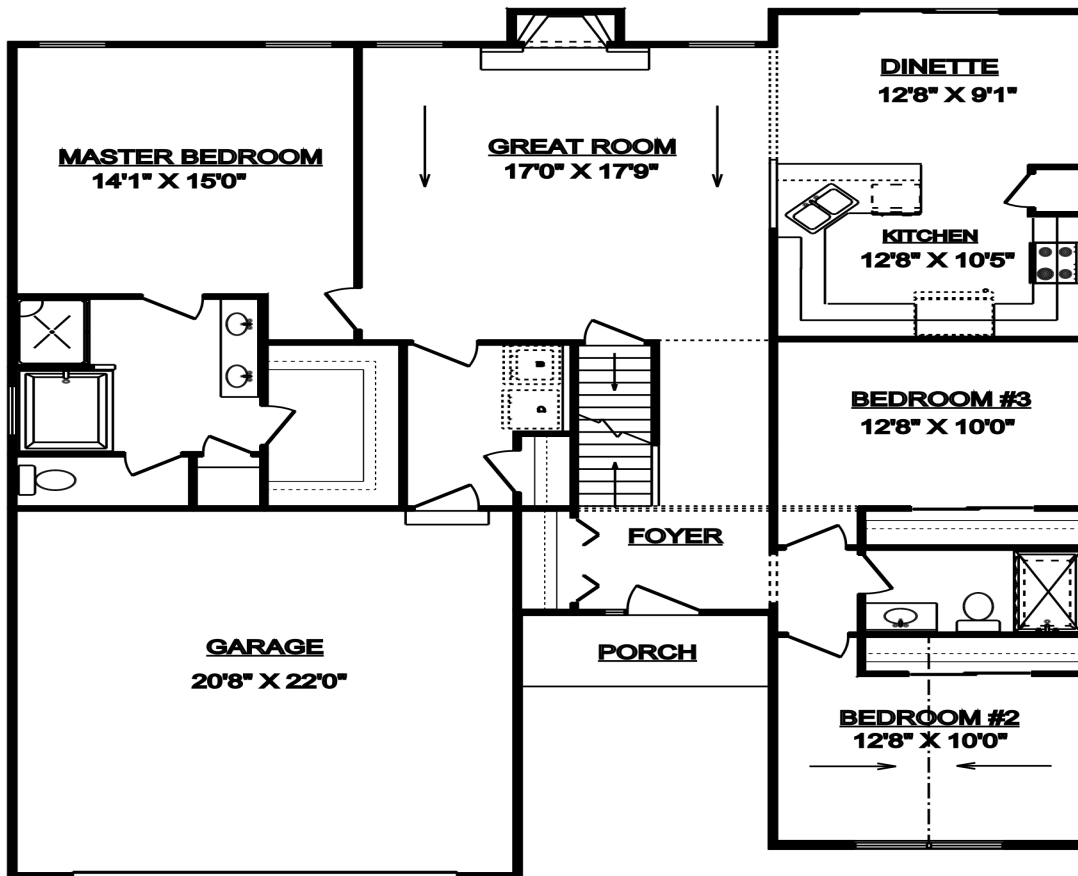

FIRST FLOOR PLAN

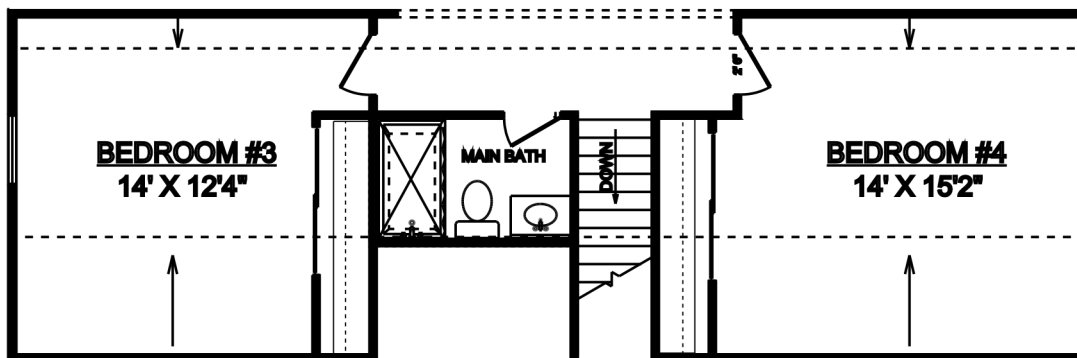

SECOND FLOOR PLAN